

RESOLUTION #06-06-22-02
APPROVING A REQUEST TO VACATE EXCESS RIGHT-OF-WAY ADJACENT TO
MITTMAN ROAD IN FRUITLAND TOWNSHIP

WHEREAS, the Muscatine County Board of Supervisors held a public hearing at 9:00 a.m. on June 6, 2022, on the proposed vacation and closure of excess right-of-way in Fruitland Township, described as follows:

Auditor's Parcel "B"

A parcel of land located in part of Government Lot 5 in the Southwest Quarter of Section 7, Township 76 North, Range 2 West of the Fifth Principal Meridian, Muscatine County, Iowa, more particularly described as follows:

Commencing at a 4"x4" concrete monument with brass tablet at the Southwest Corner of Section 7, Township 76 North, Range 2 West of the Fifth Principal Meridian, Muscatine County, Iowa; thence North 0° 12' 45" East along the west line of the Southwest Quarter of said Section, basis of bearings for this survey being the Iowa Regional Coordinate System, Zone 14 Burlington, a distance of 499.12 feet to a 5/8"Øx30" rebar with light blue cap stamped "PLS23526" set at the northwest corner of a parcel of land conveyed by warranty deed, recorded as File Number 1997-03541 in the Office of the Muscatine County Recorder; thence South 89° 47' 15" East 497.44 feet along the north line of said parcel, to a 5/8"Øx30" rebar with light blue cap stamped "PLS23526" set at the Point of Beginning; thence South 86° 31' 23" East 893.89 feet to a 5/8"Øx30" rebar with light blue cap stamped "PLS23526" set in the westerly line of the Muscatine Slough; thence South 4° 24' 04" East 82.50 feet along said westerly line to a set 5/8"Øx30" rebar with light blue cap stamped "PLS23526"; thence South 28° 55' 56" West 112.56 feet along said westerly line to a set 5/8"Øx30" rebar with light blue cap stamped "PLS23526"; thence North 77° 30' 02" West 590.42 feet to a 5/8"Øx30" rebar with light blue cap stamped "PLS23526" set at the beginning of a curve; thence northwesterly 289.64 feet along the curve concave to the northeast, having a radius of 889.93 feet and a central angle of 18° 38' 52", said curve having a chord bearing of North 68° 10' 36" West 288.36 feet to the Point of Beginning.

Said parcel contains 2.31 acres, more or less, and is subject to all easements and other restrictions of record.

And also,

Auditor's Parcel "C"

A parcel of land located in part of Government Lot 6 in the Southeast Quarter of the Southwest Quarter of Section 7 and the Northeast Quarter of the Northwest Quarter of Section 18, all in Township 76 North, Range 2 West of the Fifth Principal Meridian, Muscatine County, Iowa, more particularly described as follows:

Beginning at a 5/8"Øx30" rebar with light blue cap stamped "PLS23526" set at the Southwest Corner of the Southeast Quarter of the Southwest Quarter of Section 7, Township 76 North, Range 2 West of the Fifth Principal Meridian, Muscatine County, Iowa; thence North 0° 20' 30" East along the west line of said Southeast Quarter of the Southwest Quarter, basis of bearings for this survey being the Iowa Regional Coordinate System, Zone 14 Burlington, a distance of 22.65 feet to a 5/8"Øx30" rebar with light blue cap stamped "PLS23526" set in the southeasterly line of the Muscatine Slough; thence North 84° 17' 56" East 68.97 feet along said southeasterly line, to a set 5/8"Øx30" rebar with light blue cap stamped "PLS23526"; thence North 28° 55' 56" East 68.36 feet along said southeasterly line, to a set 5/8"Øx30" rebar with light blue cap stamped "PLS23526"; thence South 77° 30' 02" East 683.73 feet to a 5/8"Øx30" rebar with light blue cap stamped "PLS23526" set in the southerly right of way line of Mittman Road; thence South 89° 53' 56" West 51.66 feet along said right of way line, to a set 5/8"Øx30" rebar with light blue cap stamped "PLS23526"; thence North 78° 32' 46" West 299.54 feet along said right of way line, to a 5/8"Øx30" rebar with light blue cap stamped "PLS23526" set in the south line of said Southeast Quarter of the Southwest Quarter; thence South 89° 53' 56" West 424.14 feet along said south line and right of way line, to the Point of Beginning.

Said parcel contains 0.58 acres, more or less, and is subject to all easements and other restrictions of record.

and;

WHEREAS, information received at the hearing has been considered by the Muscatine County Board of Supervisors.

NOW, THEREFORE BE IT HEREBY RESOLVED by the Muscatine County Board of Supervisors that the request to vacate and close the above described roadway be approved.

PASSED AND APPROVED this 6th day of June, 2022.

ATTEST:



Tibe Vander Linden
Muscatine County Auditor

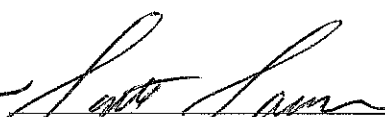

Scott Sauer, Chair
Muscatine County Board of Supervisors

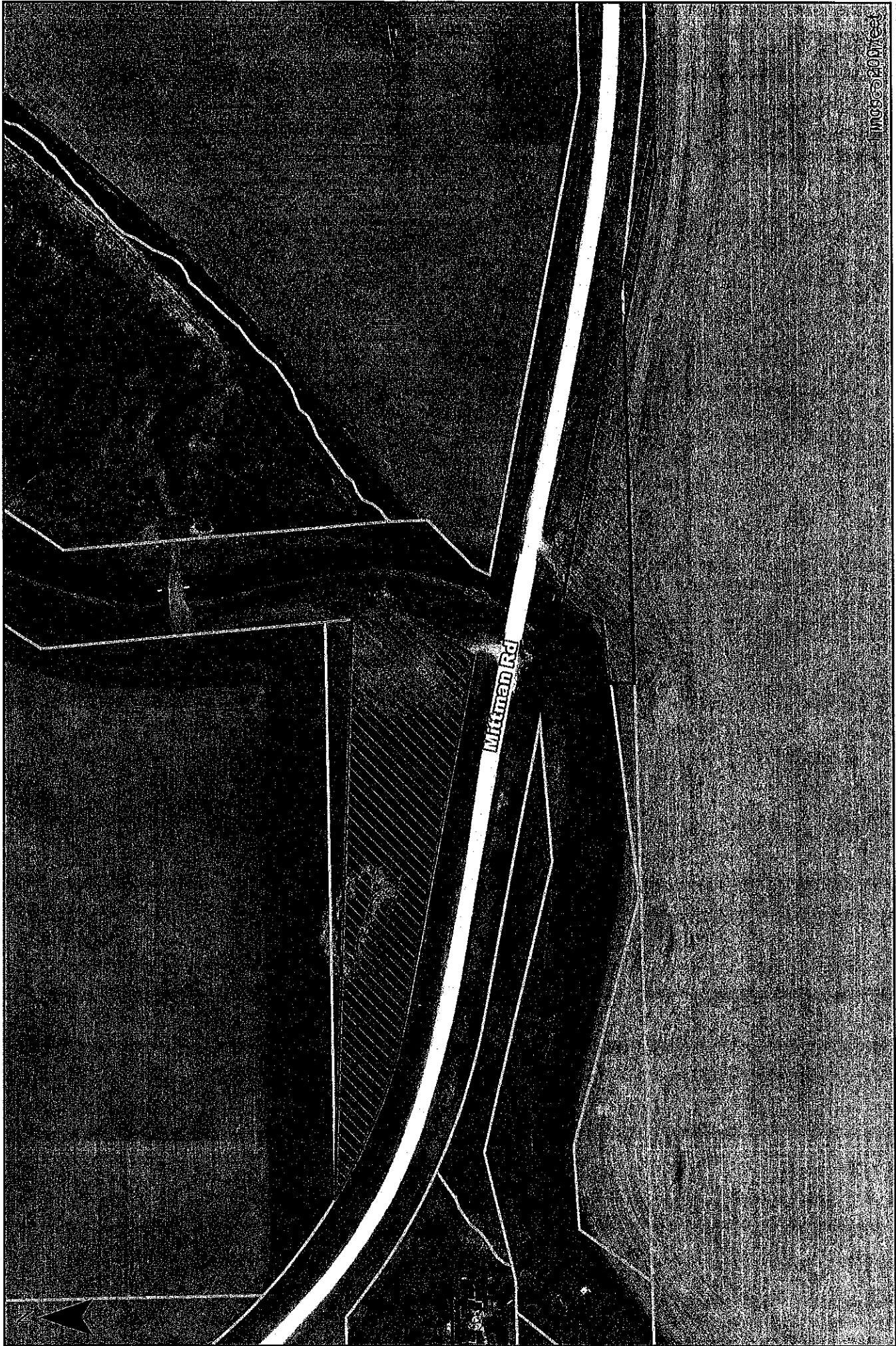

Mittman Road Vacation Exhibit



This map is a print product of the
Muscatine County Information Viewer.
All data is displayed in Iowa State
Plane South Coordinate System.

Author:

Date: 5/13/2022

Copyright: IMAGIC (Muscatine Area Geographic Information Consortium)